



Lechler GmbH  
 Precision Nozzles · Nozzle Systems  
 P.O. Box 13 23  
 72544 Metzingen / Germany  
 Phone +49 (0 71 23) 962-0  
 Telefax + 49 (0 71 23) 962-333

E-Mail: [info@lechler.de](mailto:info@lechler.de)  
 Internet: [www.lechler.com](http://www.lechler.com)

**NEW!**  
**Non-clogging**

## Full Cone Nozzles Series 490

The new generation of full cone nozzles developed via computational fluid dynamics (CFD).

- 30-40% larger free cross-sections compared to standard axial-flow full cone nozzles
- **Non-clogging.**  
**Increased operating safety**

- Spray angles are consistent over the full capacity and pressure range
- **Increased process safety**

- Excellent uniform liquid distribution
- **Uniform spray onto the product**
- Non-corrosive stainless steel 316L (1.4404)
- **Applicable in many processes with aggressive liquids and environment**

### Applications:

Cleaning and washing processes, cooling of gaseous fluids and solids, surface spraying, spraying onto mats in air washers, improving of chemical reactions.

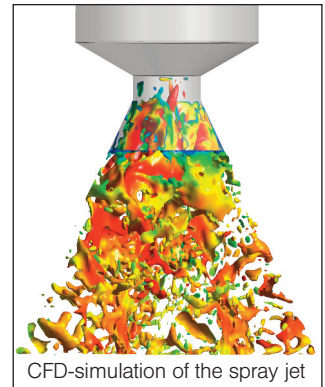
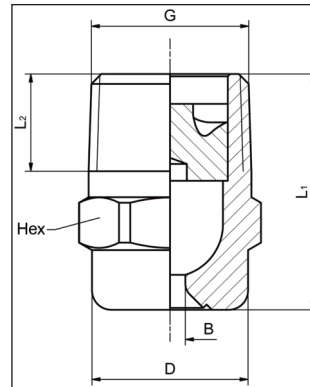

Code	Dimensions [mm]					Weight
	G	L <sub>1</sub>	L <sub>2</sub>	D	Hex	
CA	1/8 BSPT	18.0	6.5	10.0	11	13 g
CC	1/4 BSPT	22.0	10.0	13.0	14	16 g
CE	3/8 BSPT	24.5	10.0	16.0	17	28 g

Spray angle	Ordering no.			B ∅ [mm]	E ∅ [mm]	$\dot{V}$ [l/min]							Spray diameter D at p=2 bar		
	Type	Code				p [bar]							H = 200 mm	H = 500 mm	
		1/8 BSPT	1/4 BSPT			3/8 BSPT	0.5	1.0	2.0	3.0	5.0	7.0			10.0
60°	490.524.1Y	CA	-	-	1.60	1.60	1.15	1.52	2.00	2.35	2.89	3.30	3.81	220	560
	490.564.1Y	CA	-	CE	1.80	1.80	1.44	1.89	2.50	2.94	3.61	4.13	4.76	220	560
	490.604.1Y	CA	CC	CE	2.10	2.10	1.81	2.39	3.15	3.70	4.54	5.20	6.00	220	560
	490.644.1Y	-	CC	CE	2.30	2.30	2.30	3.03	4.00	4.70	5.77	6.60	7.61	220	560
	490.684.1Y	-	CC	CE	2.60	2.60	2.87	3.79	5.00	5.88	7.21	8.25	9.52	220	560
	490.724.1Y	-	CC	CE	3.00	2.80	3.62	4.77	6.30	7.41	9.09	10.40	11.99	220	560
	490.764.1Y	-	-	CE	3.30	3.30	4.59	6.06	8.00	9.41	11.54	13.20	15.22	220	560
	490.804.1Y	-	-	CE	3.70	3.70	5.74	7.58	10.00	11.76	14.43	16.51	19.04	220	560
90°	490.566.1Y	CA	-	-	1.90	1.90	1.44	1.89	2.50	2.94	3.61	4.13	4.76	380	860
	490.606.1Y	CA	-	CE	2.10	2.10	1.81	2.39	3.15	3.70	4.54	5.20	6.00	380	860
	490.646.1Y	-	CC	CE	2.40	2.40	2.30	3.03	4.00	4.70	5.77	6.60	7.61	390	960
	490.686.1Y	-	CC	CE	2.70	2.70	2.87	3.79	5.00	5.88	7.21	8.25	9.52	390	960
	490.726.1Y	-	CC	CE	3.20	2.80	3.62	4.77	6.30	7.41	9.09	10.40	11.99	390	960
	490.746.1Y	-	-	CE	3.20	3.20	4.08	5.38	7.10	8.35	10.24	11.72	13.52	390	960
	490.766.1Y	-	-	CE	3.40	3.40	4.59	6.06	8.00	9.41	11.54	13.20	15.22	390	960
	490.806.1Y	-	-	CE	3.90	3.90	5.74	7.58	10.00	11.76	14.43	16.51	19.04	390	960
490.846.1Y	-	-	CE	4.70	4.00	7.18	9.47	12.50	14.70	18.03	20.63	23.80	390	960	
120°	490.568.1Y	CA	-	-	1.90	1.90	1.44	1.89	2.50	2.94	3.61	4.13	4.76	680	1220
	490.608.1Y	CA	-	-	2.10	2.10	1.81	2.39	3.15	3.70	4.54	5.20	6.00	680	1220
	490.648.1Y	-	CC	CE	2.40	2.40	2.30	3.03	4.00	4.70	5.77	6.60	7.61	680	1330
	490.688.1Y	-	CC	CE	2.80	2.80	2.87	3.79	5.00	5.88	7.21	8.25	9.52	680	1330
	490.728.1Y	-	CC	CE	3.20	2.80	3.62	4.77	6.30	7.41	9.09	10.40	11.99	680	1330
	490.748.1Y	-	-	CE	3.20	3.20	4.08	5.38	7.10	8.35	10.24	11.72	13.52	680	1330
	490.768.1Y	-	-	CE	3.50	3.50	4.59	6.44	8.00	9.41	11.54	13.20	15.22	680	1330
	490.808.1Y	-	-	CE	3.90	3.90	5.74	7.58	10.00	11.76	14.43	16.51	19.04	680	1330
490.848.1Y	-	-	CE	4.70	4.00	7.18	9.47	12.50	14.70	18.03	20.63	23.80	680	1330	

Example for ordering:  
 Type + Code = Ordering no.  
 490.566.1Y + CA = 490.566.1Y.CA

More nozzle sizes and materials on request.