

BILL OF MATERIAL

PART NO.	DESCRIPTION	ITEM NO.	M.O.C.	QTY.
01	AIR CAP	AC.TS100.M2L	SS316L	01
02	LIQUID NOZZLE	REFER TABLE 01	SS316L	01
03	RETAINER NUT	RN.TS100.M2L	SS316L	01
04	BODY(CHAMBER BLOCK)	CB.TS100.M2L	SS316L	01
05	NEEDLE GLAND	NG.TS100.M2L	SS316L	02
06	CYLINDER	CYL.TS100.M2L	SS316L	01
07	PISTON	PISTON.TS100.M2L	SS316L	01
08	NEEDLE ASSEMBLY	NA.TS100.M2L	SS316L	01
09	NEEDLE SPRING	SP.TS100.M2L	SS316L	01
10	CYLINDER EXTENSION	CEX.TS100.M2L	SS316L	01
11	PISTON SPRING	SP.TS100.M2L	SS316L	01
12	CYLINDER EXTENSION CAP	EC.TS100.M2L	SS316L	01

TABLE - 01

SIZE	LIQUID NOZZLE
0.5	LN05.TS100.M2L
0.8	LN08.TS100.M2L
1.0	LN10.TS100.M2L
1.2	LN12.TS100.M2L
1.5	LN15.TS100.M2L
1.8	LN18.TS100.M2L
2.0	LN20.TS100.M2L
2.5	LN25.TS100.M2L

'O'RING PART REFERENCE

PART NO.	DESCRIPTION	QTY.
A	LIQUID NOZZLE 'O' RING	01
B	CHAMBER BLOCK FACE 'O'RING	01
C	LIQUID PIPE 'O'RING	02
D	CYLINDER PIPE 'O' RING	01
E	NEEDLE GLAND 'O' RING	02
F	CYLINDER 'O' RING	01
G	PISTON 'O' RING	01
H	CYLINDER (CYL. AIR SEALING)	01
I	CYLINDER EXTENSION 'O' RING	02

NOTE :- 'O' RING SET = 12 NOS. 'O' RING.
SPRING SET = 02 NOS. SPRING

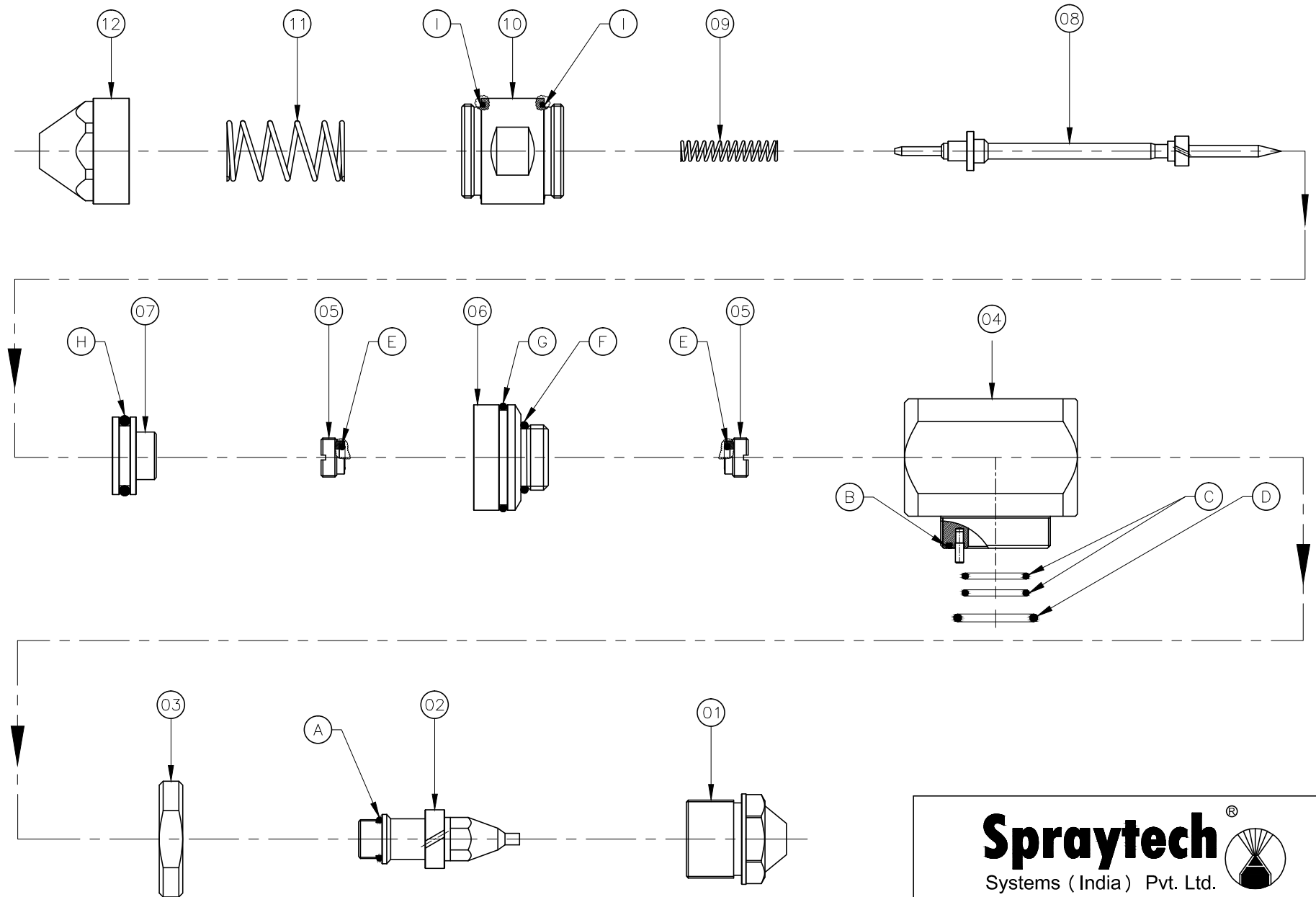
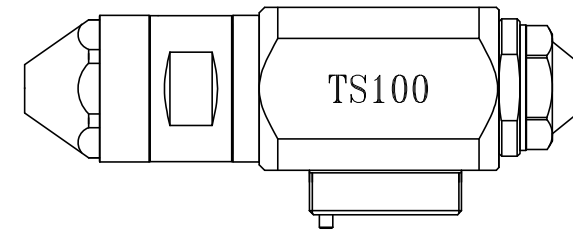

TOP SPRAY GUN DATA SHEET

MODEL NO:	TS100 (V1)	PAGE:	1 OF 1
DWG. NO. :	SPR.TSL.PL.01.22	REV.:	R1

DRN.	SANDESH	DATE	03/01/22
CHK.	RUSHI	SIGN	
APPD.	B.A.K.	SIGN	

This document is property of M/s. SPRAYTECH SYSTEMS (INDIA) PVT. LTD. Passing on and copying of this document, Utilization and communication of its contents are prohibited unless expressly authorized. Offenders will be liable for damages.